

# RELIEF VALVE - 02 / 03 SERIES

Model	Valve size	Max. pressure kg/cm <sup>2</sup>	Flow rated l/min	Pressure adjusting kg/cm <sup>2</sup>	Weight kgs
MRV-02-P-*	02	250	40	1 : 8 ~ 70 2 : 7 ~ 160 3 : 35 ~ 250	1.5
MRV-02-A/ B-*					1.6
MRV-02-W-*					2.3
MRV-03-P-*	03		50		3.1
MRV-03-A/ B-*					

MRV-02-P-\*

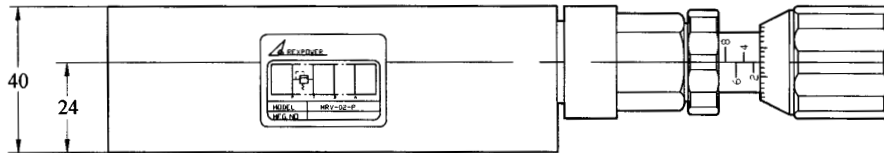
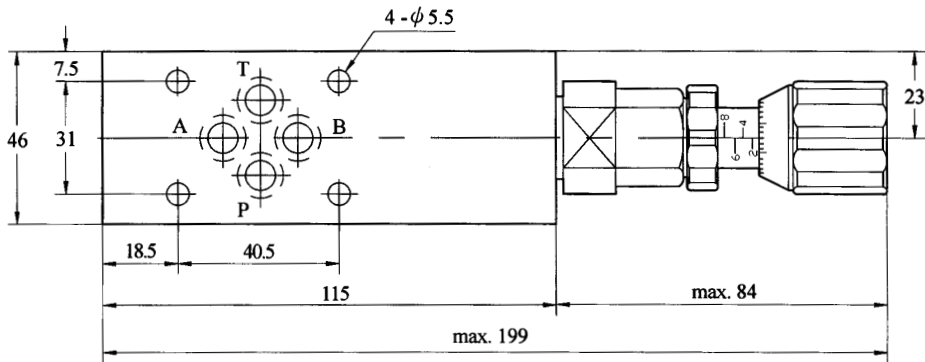

MRV-03-P-\*

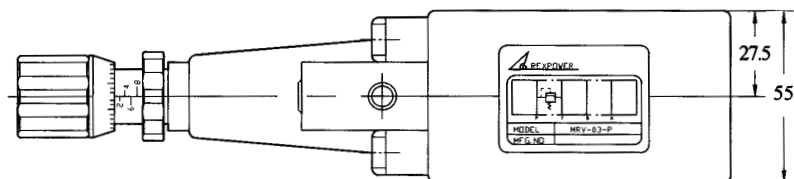
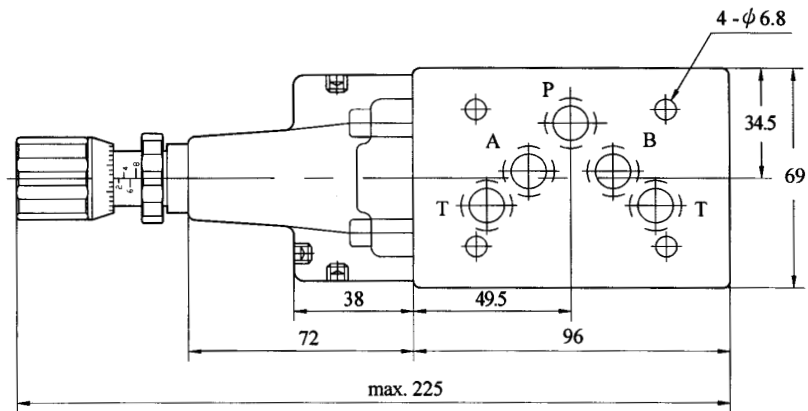

# FLOW CONTROL VALVE - 02 / 03 SERIES

Model	Valve size	Max. pressure kg/cm <sup>2</sup>	Max. Flow l/min	Cracking pressure kg/cm <sup>2</sup>	Remark	Weight kgs
MTC-02-W -*	02	250	40	0.8	* O: Meter-out I: Meter-in	1.3
MTC-02-A/ B -*						1.2
MTC-03-W -*	03		50			3.1
MTC-03-A/ B -*						3.0

MTC-02-W-O

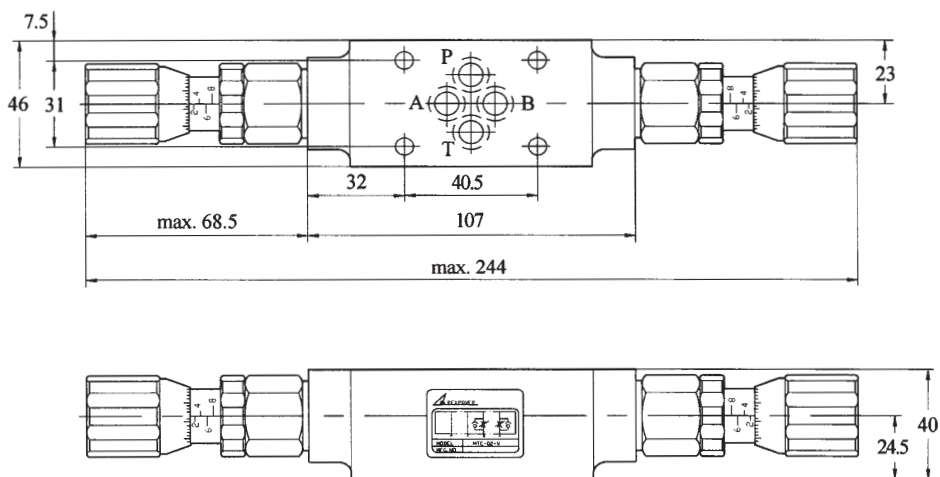

MTC-03-W-O

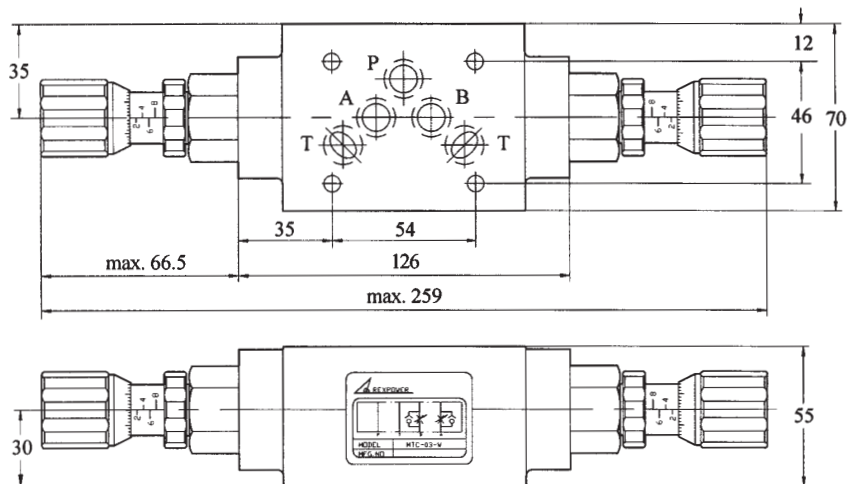

# PILOT CHECK VALVE - 02 / 03 SERIES

Model	Valve size	Max. pressure kg/cm <sup>2</sup>	Flow rated l/min	Cracking pressure kg/cm <sup>2</sup>	Weight kgs
MPC-02- W -*	02	250	40	1 : 2	1.2
MPC-02- A/B - *					
MPC-03- W -*	03		50	2 : 5	3.6
MPC-03- A/B - *					

MPC-02-W-\*

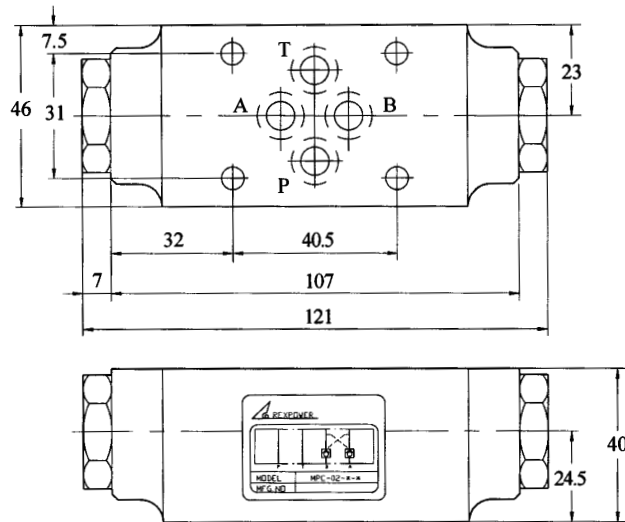

MPC-03-W-\*

